

***EXCLUSIVE FOR LEASE***  
**625 Merrick Avenue, East Meadow, NY 11520**



**Type:** Medical/Retail  
**Unit Size(s):** Up to 30,000 SF ± (Divisible)  
**Rent:** Upon Request  
**Co-Tenants:** Chiropractor, Pediatrician, Carvel, The Bagel Place, Ciro's Pizza, Chinese Restaurant, Nail Salon, Dollar Tree, Chase, Kosher Butcher and more  
**Area Tenants:** NYU Langone Ambulatory Care, Capital One, 7-Eleven, Dunkin' Donuts

Up to ± 30,000 SF of First and lower levels available at the Merrick Avenue & Bellmore Avenue split in East Meadow, NY. Located down the block from brand new NYU Langone Ambulatory Care (50,000+ SF). Ample on-premise Parking. Call for details.

**For More Information Contact:**

**Marvin Hartman**  
Licensed R.E. Associate Broker  
(516)997-0100 ext. 0309  
[mhartman@pliskinrealty.com](mailto:mhartman@pliskinrealty.com)



**PLISKIN  
REALTY AND  
DEVELOPMENT, INC.**  
*Knowledge. Service. Integrity.*

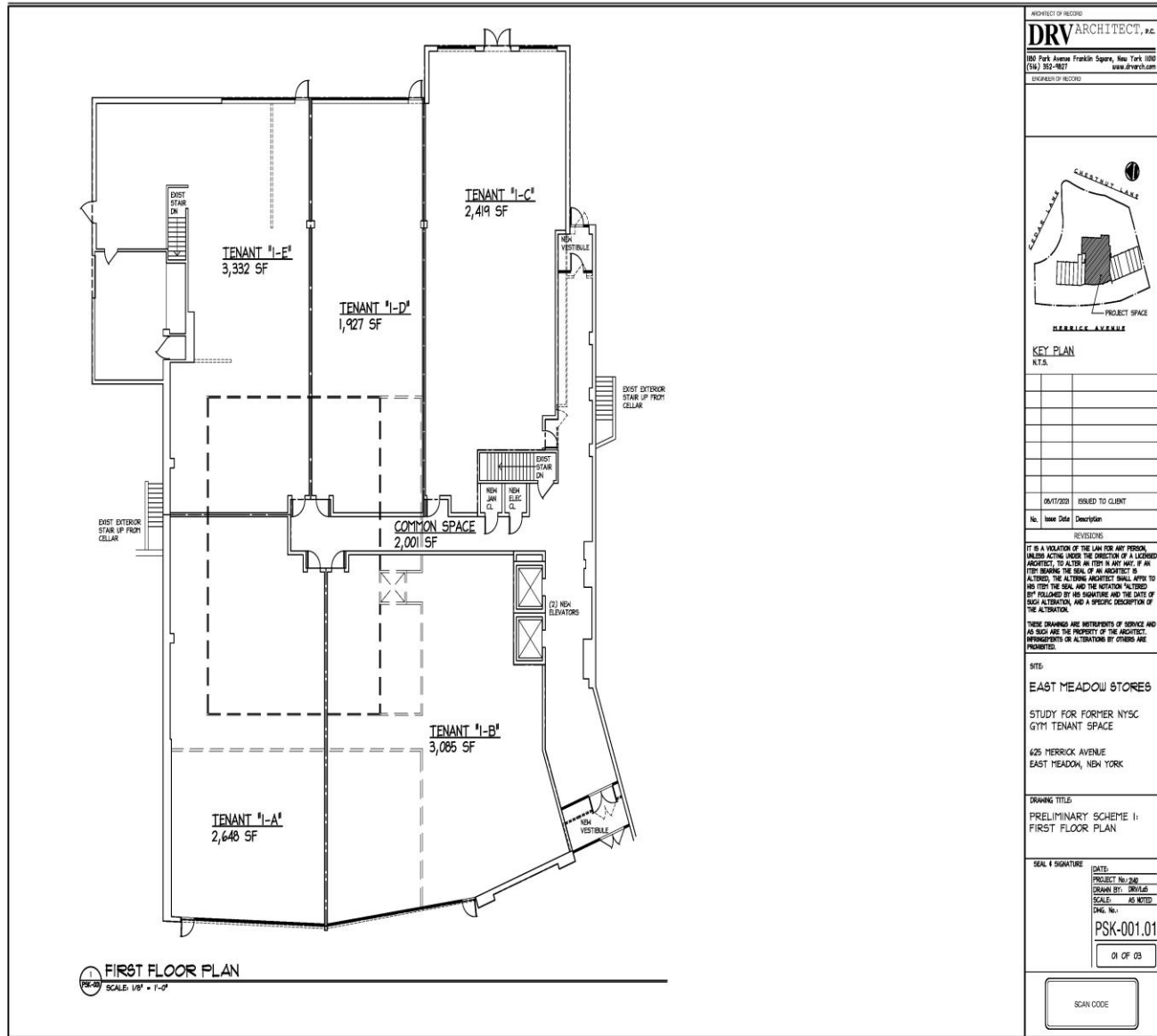

591 Stewart Avenue • Suite 100 • Garden City, NY 11530

516-997-0100 • web: www.PliskinRealty.com • E-Mail: mhartman@pliskinrealty.com



**PLISKIN  
REALTY AND  
DEVELOPMENT, INC.**  
*Knowledge. Service. Integrity.*

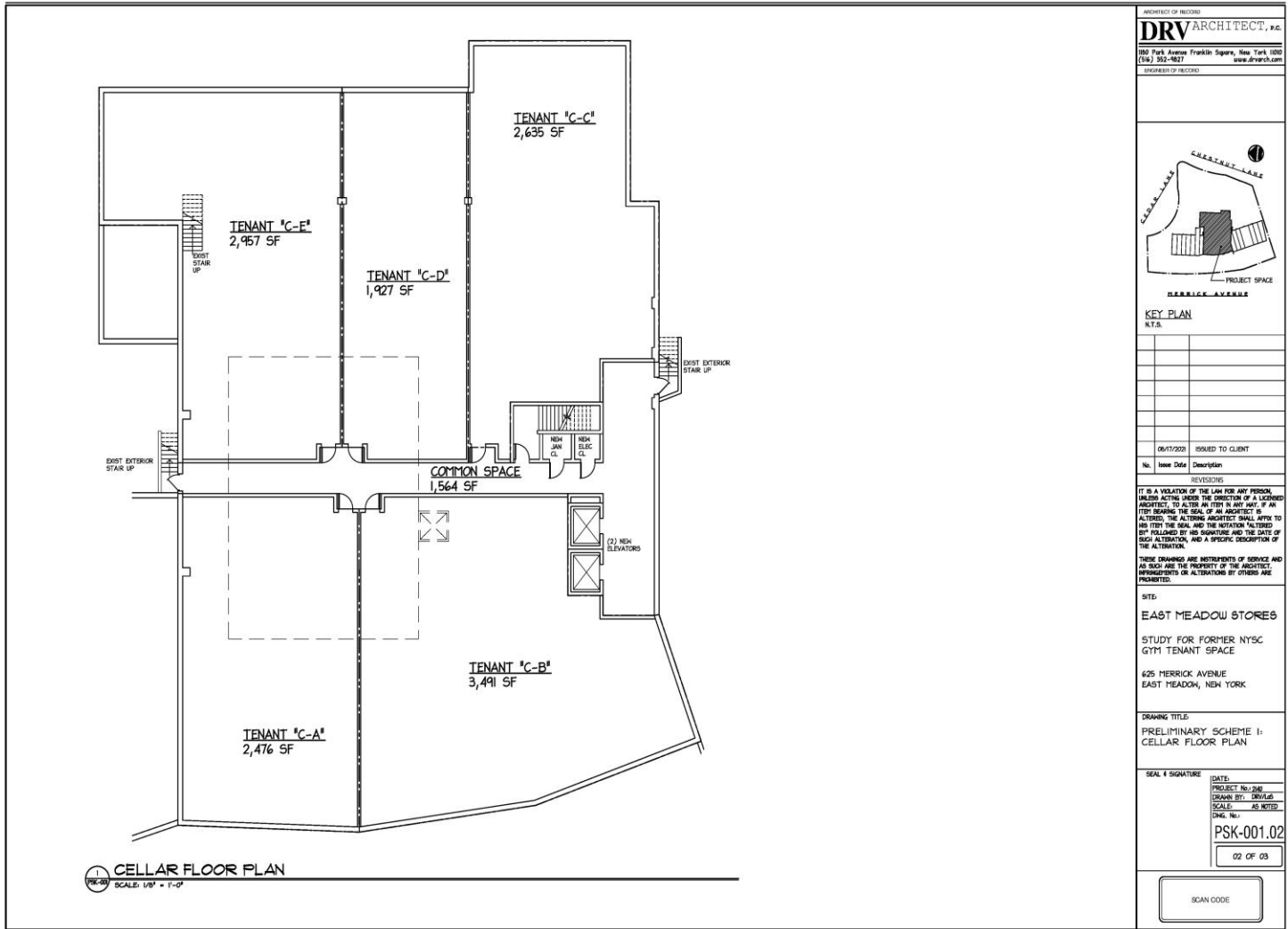

ARCHITECT OF RECORD  
**DRY ARCHITECT, P.C.**  
 180 Park Avenue Franklin Square, New York 1000  
 (516) 352-9821 www.dryarch.com  
 REGISTERED PROFESSIONAL ARCHITECT

**KEY PLAN**  
N.T.S.

No.	Issue Date	Description
06/17/2021	ISSUED TO CLIENT	

REVISIONS

IT IS A VIOLATION OF THE LAW FOR ANY PERSON, INCLUDING AGENTS UNDER THE DIRECTION OF A LICENSED ARCHITECT, TO ALTER AN SET IN ANY MANNER. IF AN SET BEARING THE SEAL OF AN ARCHITECT IS ALTERED, THE ALTERING ARCHITECT SHALL APPLY TO HIM FIRST THE SEAL AND THE NOTATION "ALTERED SET" FOLLOWED BY HIS SIGNATURE AND THE DATE OF SUCH ALTERATION, AND A SPECIFIC DESCRIPTION OF THE ALTERATION.

THESE DRAWINGS ARE INSTRUMENTS OF SERVICE AND AS SUCH ARE THE PROPERTY OF THE ARCHITECT. REPRODUCTIONS OR ALTERATIONS BY OTHERS ARE PROHIBITED.

SITE:  
 EAST MEADOW STORES  
 STUDY FOR FORMER NYSC GYM TENANT SPACE  
 625 HERRICK AVENUE  
 EAST MEADOW, NEW YORK

DRAWING TITLE:  
 PRELIMINARY SCHEME 1:  
 CELLAR FLOOR PLAN

SEAL & SIGNATURE

DATE:	PROJECT No.:
DRAWN BY:	SCALE:
SHEET No.:	PSK-001.02
	02 OF 03

SCAN CODE